

THE COPYRIGHT OF THIS DRAWING IS VESTED WITH CW O'BRIEN ARCHITECTS LIMITED AND MUST NOT BE COPIED OR REPRODUCED WITHOUT THE CONSENT OF THE COMPANY.

FIGURED DIMENSIONS ONLY TO BE TAKEN FROM THIS DRAWING. DO NOT SCALE.

ALL CONTRACTORS MUST VISIT THE SITE AND BE RESPONSIBLE FOR CHECKING ALL SETTING OUT DIMENSIONS AND NOTIFYING THE ARCHITECT OF ANY DISCREPANCIES PRIOR TO ANY MANUFACTURE OR CONSTRUCTION WORK.

NOTES:

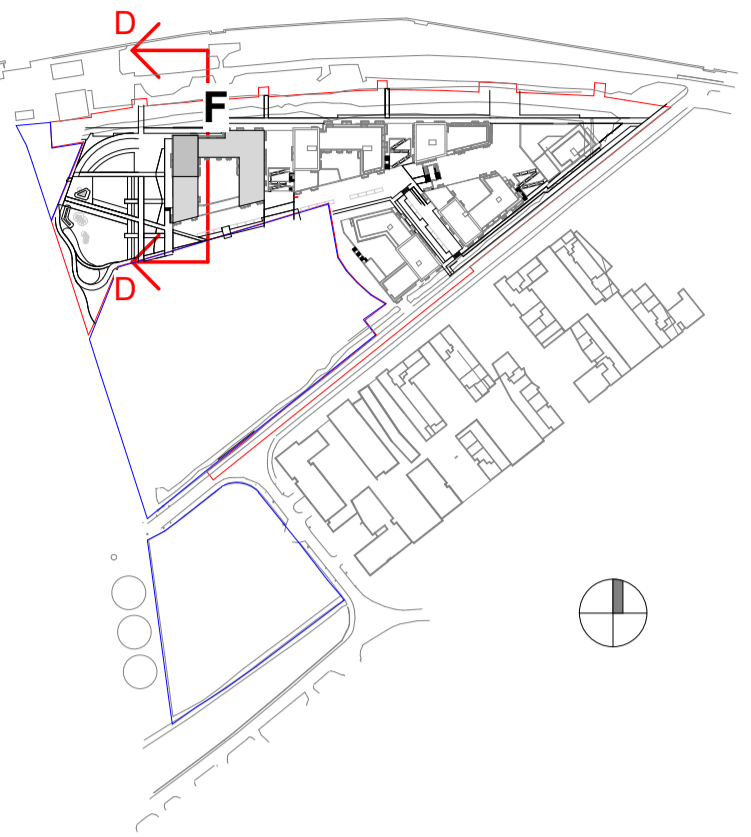

**1** BLOCK F-SECTION D-D  
1 : 200

- LEGEND**
- NOTE 1:  
PROPOSED FINISH : SELECTED WHITE STONE FINISH.  
REFER TO DESIGN STATEMENT FOR MORE INFORMATION.
- NOTE 2:  
PROPOSED FINISH : SELECTED BROWN BRICK FINISH.  
REFER TO DESIGN STATEMENT FOR MORE INFORMATION.
- NOTE 3:  
PROPOSED FINISH : SELECTED DARK GREY BRICK FINISH.  
REFER TO DESIGN STATEMENT FOR MORE INFORMATION.
- NOTE 4:  
PROPOSED FINISH : SELECTED LIGHT GREY BRICK FINISH.  
REFER TO DESIGN STATEMENT FOR MORE INFORMATION.
- NOTE 5:  
PROPOSED FINISH : SELECTED WHITE BRICK FINISH.  
REFER TO DESIGN STATEMENT FOR MORE INFORMATION.
- NOTE 6:  
PROPOSED FINISH : SELECTED METAL FINISH - BRONZE FINISH.  
REFER TO DESIGN STATEMENT FOR MORE INFORMATION.
- NOTE 7:  
PROPOSED GLASS BALCONY FINISH :  
INCLUDING BRONZE FINISH TO FACE OF BALCONY DECK.
- NOTE 8:  
PROPOSED FINISH : CHARCOAL POWER-COATED ALUMINIUM / PVC FRAME WINDOWS / DOORS.
- NOTE 9:  
PROPOSED DARK SPANDREL PANEL FINISH :  
REFER TO DESIGN STATEMENT FOR MORE INFORMATION.
- NOTE 10:  
PROPOSED FINISH : SELECTED LIGHT GREY ALUMINIUM VERTICAL FRAME FINISH.  
REFER TO DESIGN STATEMENT FOR MORE INFORMATION.

Rev	Date	Description	Issued By
P06	28/03/2022	ISSUED FOR PLANNING	EB
P05	25/03/2022	ISSUED FOR PLANNING	EB
P04	07/03/2022	ISSUED FOR REVIEW	EB
P03	03/03/2022	ISSUED FOR PLANNING	EB
P02	08/10/2021	ISSUED FOR PRE-PLANNING	EB
P01	24/09/2021	ISSUED FOR REVIEW	EB

**AREA TYPES**

- 1 BED
- 2 BED
- 3 BED
- 3 BED - DUPLEX
- CAR PARK
- SERVICES
- CIRCULATION
- RETAIL
- COMMUNAL AMENITY
- BAR/ CAFE
- CRECHE
- BIKE
- NEIGHBOURHOOD CENTRE

Project Stage

**PLANNING**

Client:  
Tiznow Property Company Limited  
(Comer Group Ireland)

Project:  
City Park Development  
at the Former Tedcastles Site,  
Centre Park Road, Cork

Drawing Title:  
BLOCK F-SECTION-SHEET 4 OF 5

Drawn	Checked	Paper Size	Scale	Date
VF	EB	A1	As indicated	09/13/21

Project No.	Drawing No.	Classification	Revision
PE21055	2713		P06

File Name:  
PE21055-CWO-06-ZZ-DR-A-2713

Status:  
**A1 - Authorized and accepted for planning stage**



No.1 Sarsfield Quay, Dublin 7, D07 R9FH  
t: 01 518 0170 e: admin@cwoarchitects.ie  
Dublin | Cork | Galway | London | UK & Europe +  
www.cwoarchitects.ie

Please consider the environment before printing this sheet